

Floorplan

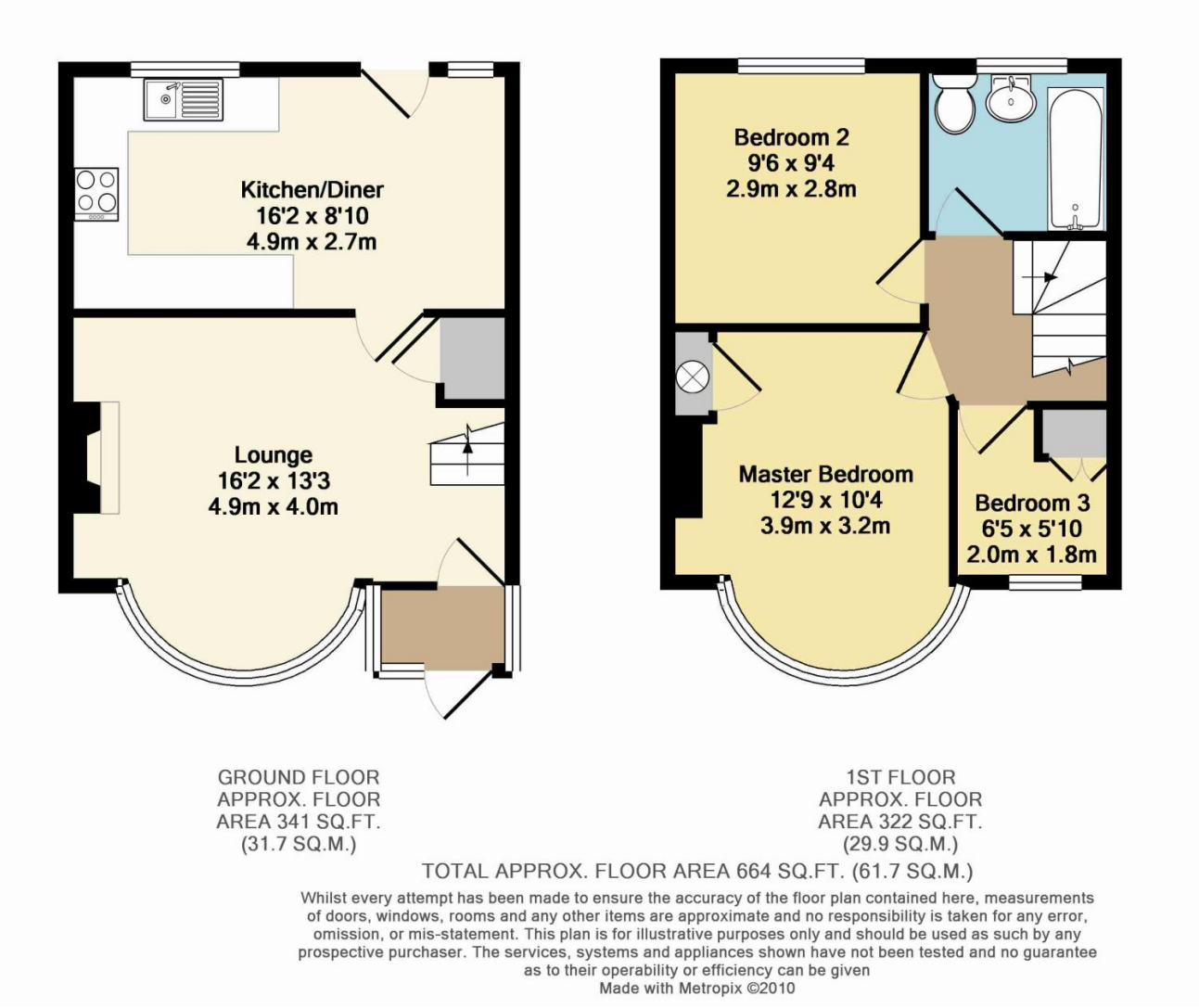

Every care has been taken with the preparation of these Particulars but complete accuracy cannot be guaranteed. Always check the details before agreeing to purchase, This includes checking on the existence of relevant permissions. If there is any point, which is of particular importance to you, please obtain professional confirmation. Alternatively, we will be pleased to check the information for you. All measurements quoted are approximate. The Fixtures, Fittings & Appliances have not been tested and therefore no guarantee can be given that they are in working order. Photographs are reproduced for general information and it cannot be inferred that any item shown is included in the sale. Drawings/Sketches/Plans - This representation is provided for general guidance and is not to scale.



Brixham Crescent
Ruislip



Lawrence Rand
Estate Agents





Brixham Crescent Ruislip £1,350 per month

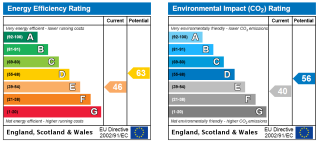

Key features

- Mid terrace house
- Three bedrooms
- Spacious kitchen/diner
- Off street parking

Property details

This three bedroom mid terrace B Type manor home is presented in good order throughout.

The property comprises of an entrance lobby, open plan living area with stairs to the first floor. Spacious kitchen/diner with a range of wall and base units.

To the first floor there are three bedrooms, two double bedrooms and a single and a fully tiled fitted bathroom.

There is a large rear garden with patio area and an attractive block paved frontage which provides off street parking.

The property is ideally located only minutes from Ruislip Manor with its many shops and good transport links (buses and tubes (Metropolitan/Piccadilly Line) with the A40/Western Avenue only a very short drive away, providing swift access into Central London and the surrounding Home Counties.



We are local people who support our local community. We have unrivalled expertise and knowledge of the surrounding area

0208 866 2727
lawrence-rand.co.uk

Lawrence Rand
Estate Agents